

Large Format Telecentric Lens

Model		VS-TCM07-150/S			
Optical Mag.		× 0.7 ± 5 %			
FOV (V x H)	1"	16.1	×	16.1	mm
	2/3"	10.1	×	12.0	mm
	1/2"	6.9	×	9.1	mm
WD		150.8 mm ± 4.5			
O/I (Object & Imager Distance)		373.8 mm			
Working F/# *Value at Iris Open		5.3			
NA		0.066			
DOF at PCoC ϕ 0.04mm		0.9 mm			
TV Distortion (1")		0.01 %			
Relative Illuminance (Y=9)		99 %			
Wavelength		Visible			
Mount		C-Mount			
Flange Back		17.526 mm			
Image Circle		ϕ 18 mm			
Co-Axial Prism		-			
Filter Thread		M 55 P= 0.75			
Weight (approx.)		580 g			
Dimension		ϕ 57 (max.) × L = 205.5 mm			

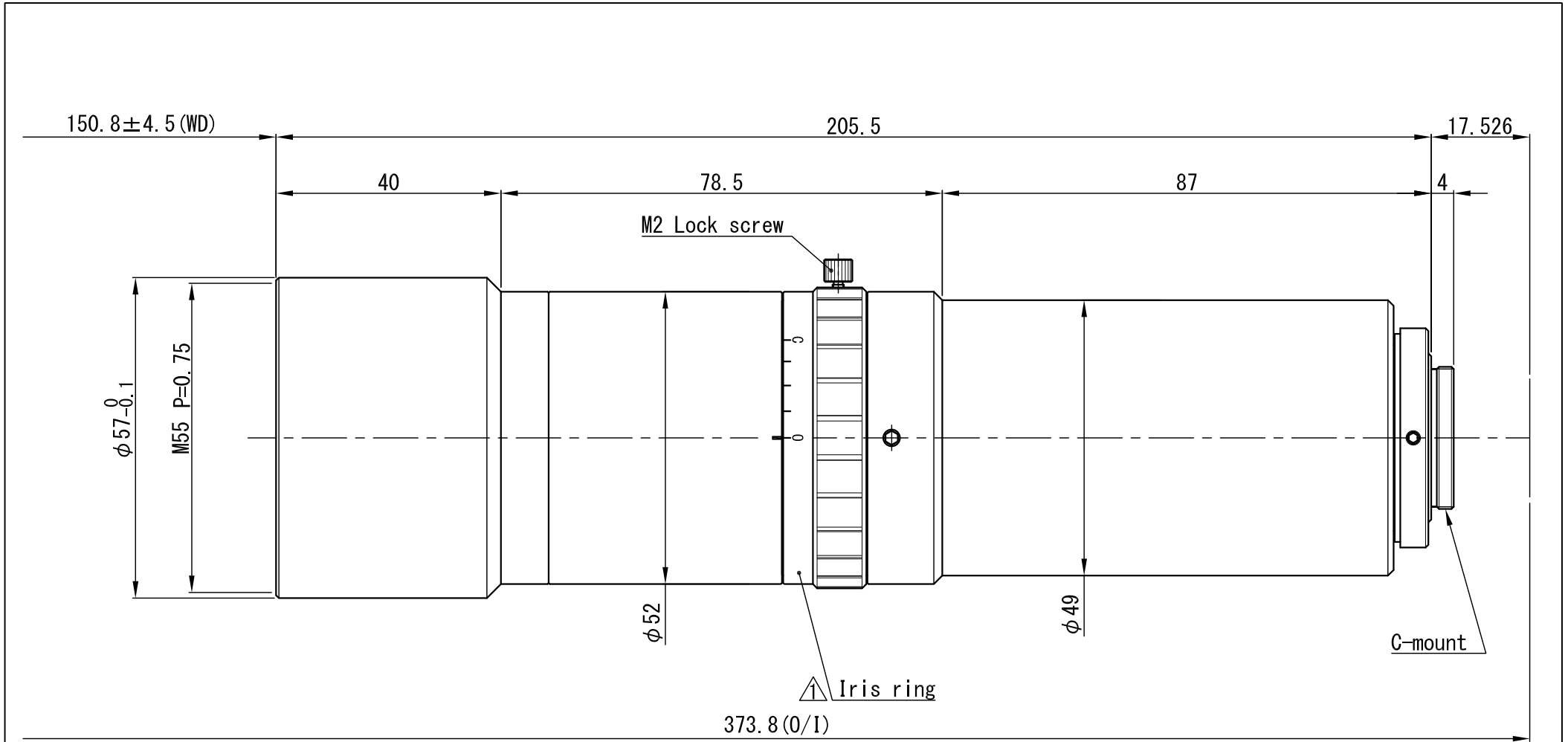

$\triangle \times$				APPROVED	CHECKED	MATERIAL 材料	-	CHAMFER 一般面取	-	QUANTITY 個数	
$\triangle \times$				T. A.	T. A.	TREATMENT 処理	-	FINISHING 仕上	-	-	
$\triangle \times$						TREATMENT CONTACT 処理接点	-	DECENTRATION 偏芯	-		
$\triangle \times$				DESIGNED	DRAWN	OVER 250 UP TO 1000	± 0.3 ± 0.5 ± 1.0 ± 0.2	ANGLE 角度	METHOD 図法	REMARK 適用 (機種名)	
$\triangle \times$				T. A.	S. K.	OVER 63 UP TO 250	± 0.2 ± 0.3 ± 0.6 ± 0.15	UNIT (mm)	-	VS-TCM07-150/S	
$\triangle \times 1$	Iris ring表記追加	19.03.03	T. F.			OVER 16 UP TO 63	± 0.1 ± 0.2 ± 0.4 ± 0.1				SCALE
NO. x 箇所	REVISION 訂正事項	DATE	NAME			TOLERANCES	A B C S	DATE	11.05.09	DRAW NO.	01DTC0475A2