

Large Format Telecentric Lens

Model		VS-TCM3-50CO			
Optical Mag.		× 3.0 ± 5 %			
FOV (V x H)	1"	3.8	×	3.8	mm
	2/3"	2.4	×	2.8	mm
	1/2"	1.6	×	2.1	mm
WD		53.9 mm ± 2.5			
O/I (Object & Imager Distance)		186.9 mm			
Working F/#		15.0			
NA		0.100			
DOF at PCoC ϕ 0.04mm		0.1 mm			
TV Distortion (1")		0.32 %			
Relative Illuminance (Y=9.25)		93 %			
Wavelength		Visible			
Mount		C-Mount			
Flange Back		17.526 mm			
Image Circle		ϕ 18.5 mm			
Co-Axial Prism		Built-in			
Weight (approx.)		120 g			
Dimension		ϕ 31 (max.) × L = 115.5 mm			

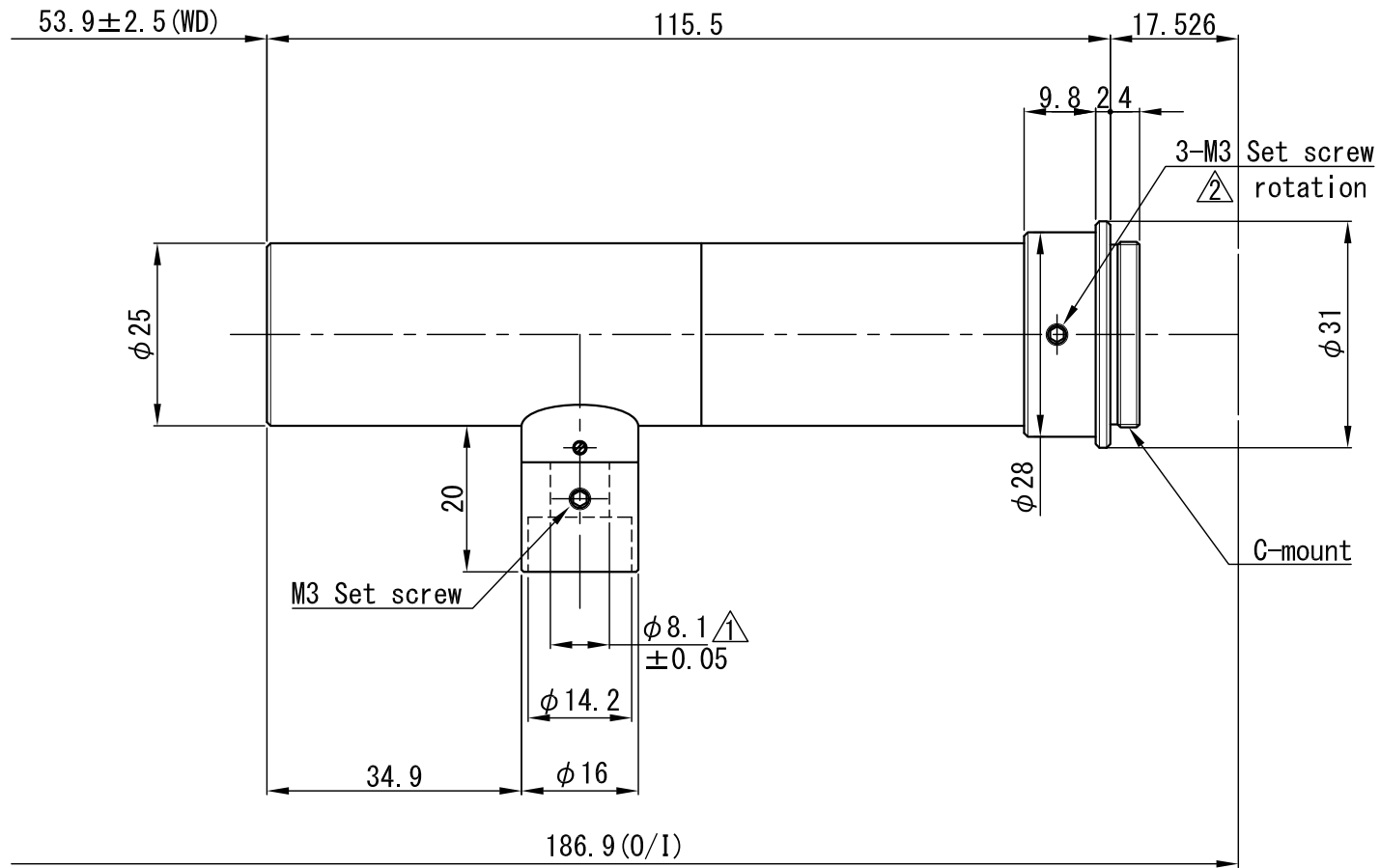

△×				APPROVED	CHECKED	MATERIAL 材料	-	CHAMFER 一般面取	-	QUANTITY 個数					
△×				T. A.	T. A.	TREATMENT 処理	-	FINISHING 仕上	-	-					
△×						TREATMENT CONTACT 処理接点	-	DECENTRATION 偏芯	-						
△×				DESIGNED	DRAWN	OVER 250 UP TO 1000	±0.3	±0.5	±1.0	±0.2	UNIT (mm)	ANGLE 角度	METHOD 図法	REMARK 適用 (機種名)	
△×1	rotation 表記追加	19.03.03	T. F.			OVER 63 UP TO 250	±0.2	±0.3	±0.6	±0.15		-	V S - T C M 3 - 5 0 C 0		
△×1	φ8(+0.02/0) → φ8.1(±0.05)	18.08.29	S. U.			OVER 16 UP TO 63	±0.1	±0.2	±0.4	±0.1		SCALE		1 / 1	NAME
NO.×箇所	REVISION 訂正事項	DATE	NAME			T. T.	S. K.	OVER 0 UP TO 16	±0.05	±0.1		±0.2	±0.1	SCALE	DATE
						TOLERANCES	A	B	C	S					