

(O/I 239.61)

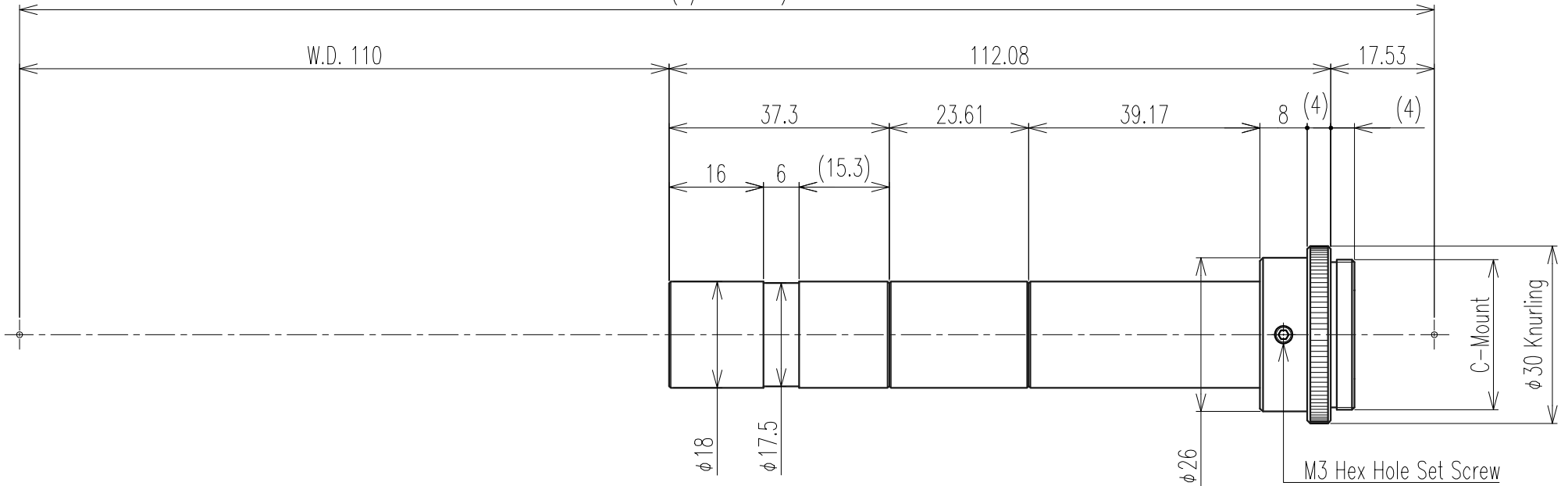

**Optical Spec**

Mag.	$\times 6 \pm 0.18$ ( $\pm 3\%$ )	Resolution	6.7 $\mu\text{m}$
W.D.	$110 \pm 3.3$ mm	Optical Distortion	0.48 %
Eff. F.No.	60.0	TV Distortion	0.16 %
N.A.	0.050		
D.O.F.	0.18 mm		

**Notice**

Compatible Camera : $\leq \frac{2}{3}$ "	CoC 40 $\mu\text{m}$
Calculation conditions	D.O.F. = 0.13 mm
Compatible pixel : 10 $\mu\text{m}$	
Correspond $\lambda$ : 550 nm	
Correct Iris Stop : $\phi$ mm	

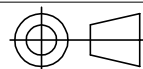

THIRD ANGLE  
PROJECTION  
UNIT : mm

SCALE	DATE	MODEL NAME
1 : 1	2015.06.23	TV-6M-110